

Spiral Hardware,
6 Barnes Close,
Brandon, Suffolk
IP27 0NY

TEL: +44 (0)1842 816086
FAX: +44 (0)1842 815515
WEB: www.spiralhardware.co.uk
E-MAIL: info@spiralhardware.co.uk

Copyright (c) - April 2008, All Rights Reserved

800x800

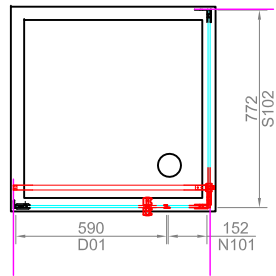

900x900

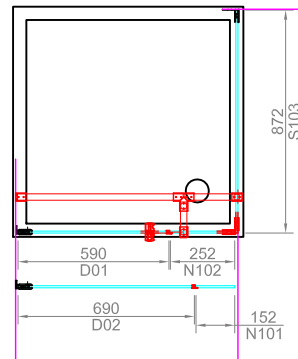

1000x1000

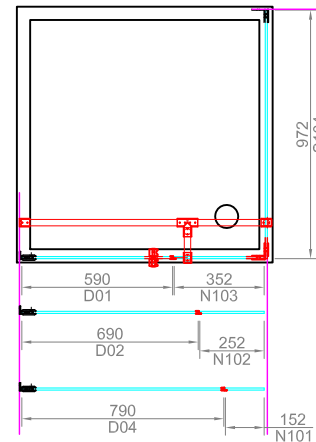

1100x700

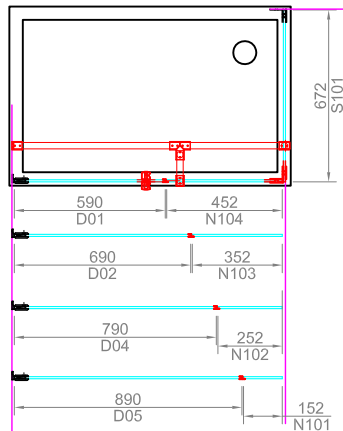

1200x700

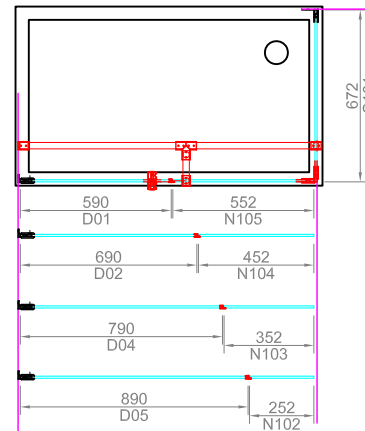

NOTES/SPECIFICATION:

TWO SIDED JAMB PANEL

GLASS PANELS REQUIRED TO CONSTRUCT SHOWER ENCLOSURES.

NOTE: 10mm ALLOWANCE FOR TILES OVER TRAY.

FRONT PANELS SET IN 15mm FROM TRAY EDGE.

SIDE PANEL SET IN 21mm FROM TRAY EDGE.

HARDWARE REQUIRED:

- 2 X GLASS TO WALL BRACKETS (SH/APH/B01)
- 2 X BASE BRACKETS (SH/APH/B05)
- 2 X GLASS TO GLASS BRACKETS (SH/APH/B02)
- 2 X GLASS TO WALL HINGES (SH/APH/H01)
- 1 X HINGE SEAL (SH/GGA/S05)
- 1 X FLOOR SEAL (SH/GGA/S04)
- 1 X CLOSURE SEAL (SH/GGA/S10)
- 1 X DOOR KNOB (SH/APH/K01)
- 1 X TIE-BAR WALL CONNECTOR (SH/APH/T08)
- 1 X TIE-BAR (SH/APH/T06 = 1m) / (SH/APH/T07 = 2m)
- 2 X TIE-BAR GLASS CONNECTOR (SH/APH/T09)
- 1 X TIE-BAR 'T' PIECE (SH/APH/T12)
- 1 X TIE-BAR COMPLETE (N101 ONLY UP TO 1000mm) (SH/APH/T01)

ALTERNATIVE HARDWARE STYLES AVAILABLE.

DRAWN BY:

DATE:

PRODUCT REF:

DESCRIPTION:

DRAWING REF:

